

**Dimension: (UNIT:mm)**

A	35.3 ± 0.8
B	22.5 ± 0.15
C	5.5 ± 0.2
D	3.7 ± 0.3
F	15.1 ± 0.75
G	16.7 ± 0.4
H	24.0 ± 0.2

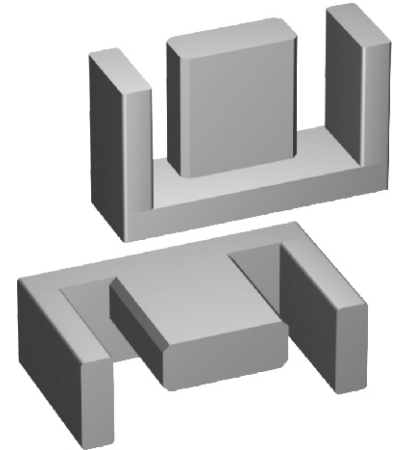
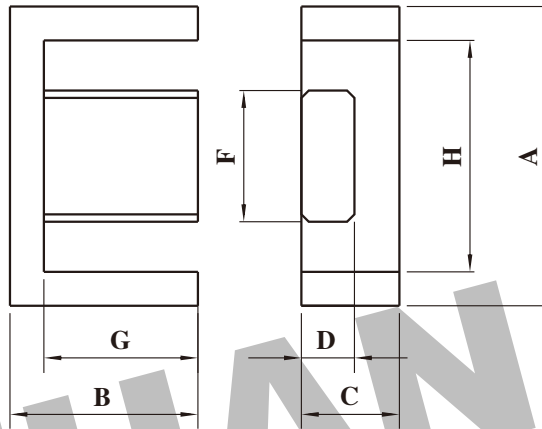

**Test conditions**

AL: F=1.0KHz U=0.3V N=10Ts

**Effective parameter**

C1(mm) <sup>-1</sup>	Ae(mm <sup>2</sup> )	Le(mm)	Ve(mm <sup>3</sup> )	Weight(g)
1.66	56.6	93.9	5315	≈14.5

**Core halves**

AL measured in combination with a non-gapped core half, clamping force for AL measurements, 70+/-20N

**Properties of core sets under power conditions**

Grade	AL (nH)	$\mu e$	AIR GAP $\mu m$	Type number
P3	160 ± 3%	≈ 125	≈ 690	EFD34-P3
	250 ± 3%	≈ 196	≈ 390	EFD34-P3
	315 ± 5%	≈ 247	≈ 290	EFD34-P3
	400 ± 8%	≈ 314	≈ 210	EFD34-P3
	630 ± 10%	≈ 494	≈ 120	EFD34-P3
	1850 ± 25%	≈ 1720	≈ 0	EFD34-P3
P4	160 ± 3%	≈ 125	≈ 690	EFD34-P4
	250 ± 3%	≈ 196	≈ 390	EFD34-P4
	315 ± 5%	≈ 247	≈ 290	EFD34-P4
	400 ± 8%	≈ 314	≈ 210	EFD34-P4
	630 ± 10%	≈ 494	≈ 120	EFD34-P4
	1850 ± 25%	≈ 1720	≈ 0	EFD34-P4
HQ2KA	1500 ± 25%	≈ 1560	≈ 0	EFD34-HQ2KA
HQ2K	160 ± 3%	≈ 125	≈ 690	EFD34-HQ2K
	250 ± 3%	≈ 196	≈ 390	EFD34-HQ2K
	315 ± 5%	≈ 247	≈ 290	EFD34-HQ2K
	400 ± 8%	≈ 314	≈ 210	EFD34-HQ2K
	630 ± 10%	≈ 494	≈ 120	EFD34-HQ2K
	1500 ± 25%	≈ 1560	≈ 0	EFD34-HQ2K
	P5	1400 ± 25%	≈ 1170	≈ 0

Grade	B (mT) at	Core loss (w) at			
	H=250 A/m F=25KHz T=100°C	F=25 KHz B=200mT T=100°C	f=100 KHz B=100mT T=100°C	F=100 KHz B=200mT T=100°C	F=400 KHz B=50mT T=100°C
P3	≥ 330	≤ 0.6	≤ 0.64	-	-
P4	≥ 330	-	≤ 0.53	≤ 3.1	-
HQ2KA	≥ 340	-	≤ 0.42	≤ 2.6	≤ 0.92
HQ2K	≥ 315	-	≤ 0.64	-	≤ 1.1
P5	≥ 300	-	-	-	≤ 0.6

**Properties of core sets under power conditions (continued)**

Grade	B (mT) at	Core loss (w) at				
	H=250 A/m F=25KHz T=100°C	F=500 KHz B=50mT T=100°C	F=500 KHz B=100mT T=100°C	F=1.0 MHz B=30mT T=100°C	F=1.0MHz B=50mT T=100°C	F=3.0MHz B=10mT T=100°C
P3	≥ 330	-	-	-	-	-
P4	≥ 330	-	-	-	-	-
HQ2KA	≥ 340	≤ 1.9	-	-	-	-
HQ2K	≥ 315	-	-	-	-	-
P5	≥ 300	≤ 0.8	≤ 4.8	-	-	-

**Note:**

- 1: Document is the property of FUAN Inc & is not allow to be duplicated without authorization
- 2: RoHS compliant.